

PIPES

Dimensions of Centrifugally Cast Ductile Iron Pipes with Screwed / Welded Flanges

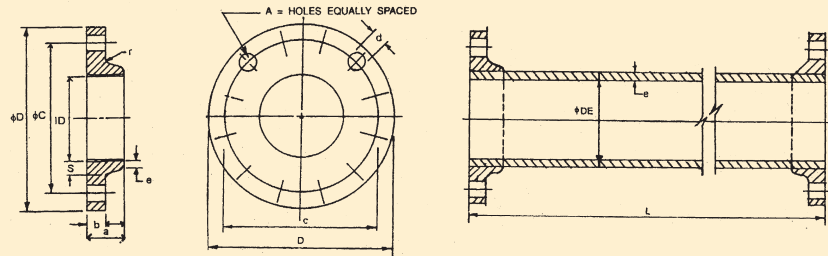

TABLE - 5

Nominal Diameter	Outside Diameter	Wall Thickness	App. Mass of One Flange		App. Mass of Barrel/mtr.	Approx Mass of One working Length "L" including two flanges							
			PN-10	PN-16		PN - 10				PN - 16			
DN	DE	e	PN-10	PN-16	Non-CML	2.75M	5.0M	5.5M	6.0M	2.75M	5.0M	5.5M	6.0M
80	98	6.0	3.5	3.5	12.4	41	69	75	81	41	69	75	81
100	118	6.0	3.8	3.8	15.1	49	83	91	98	49	83	91	98
125	144	6.0	4.7	4.7	18.6	61	102	112	121	61	102	112	121
150	170	6.0	5.8	5.8	22.1	72	122	133	144	72	122	133	144
200	222	6.3	7.8	7.8	30.5	99	168	183	199	99	168	183	199
250	274	6.8	12.0	12.0	40.8	136	228	248	269	136	228	248	269
300	326	7.2	15.2	16.0	51.5	172	288	314	340	174	290	315	341
350	378	7.7	18.6	23.7	64.0	213	357	389	421	223	367	399	431
400	429	8.1	23.4	29.8	76.5	257	430	468	506	270	442	481	519
450	480	8.6	26.6	38.1	91.0	303	508	554	599	326	531	577	622
500	532	9.0	32.6	49.7	105.7	356	594	646	699	390	628	681	733
600	635	9.9	45.5	73.7	138.9	473	786	855	925	529	842	912	981
700	738	10.8	61.3	83.0	176.3	607	1004	1092	1181	651	1048	1136	1224
750	790	11.3	74.2	96.0	197.6	692	1136	1235	1334	735	1180	1279	1377
800	842	11.7	82.2	108.3	218.1	764	1255	1364	1473	816	1307	1416	1525
900	945	12.6	99.8	131.2	263.8	925	1518	1650	1782	988	1581	1713	1845
1000	1048	13.5	126.0	178.8	313.5	1114	1820	1976	2133	1220	1925	2082	2239
1100	1152	14.4	158.0	210.4	367.8	1327	2155	2339	2523	1432	2260	2444	2627
1200	1255	15.3	188.5	271.5	425.8	1548	2506	2719	2932	1714	2672	2885	3098

NOTE :

1. The method of screwing and the exact form of thread are as per our own discretion as the flanges are never removed after screwing on to the barrel of the pipes.
2. If so required the flanges may be spot welded on the back side after screwing.
3. Alternatively the flanges may be completely welded on to the barrel pipes.
4. Pipes = K 9
5. ONLY WELDABLE FLANGES MAY ALSO BE SUPPLIED TO BE WELDED ON TO THE PIPES AS PER SITE REQUIREMENTS